

TOILETS NEAR POOL

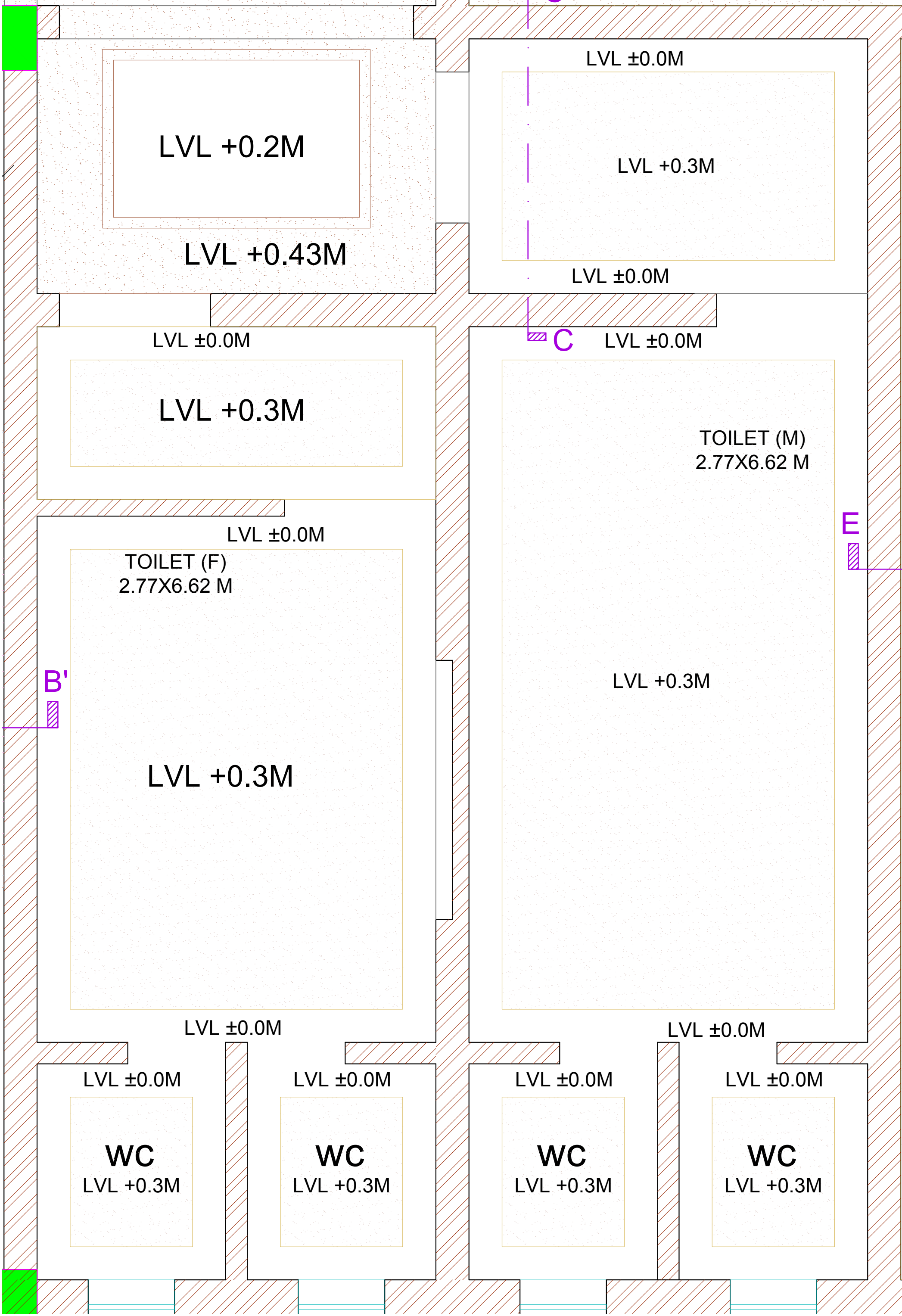

TOILETS IN LOBBY

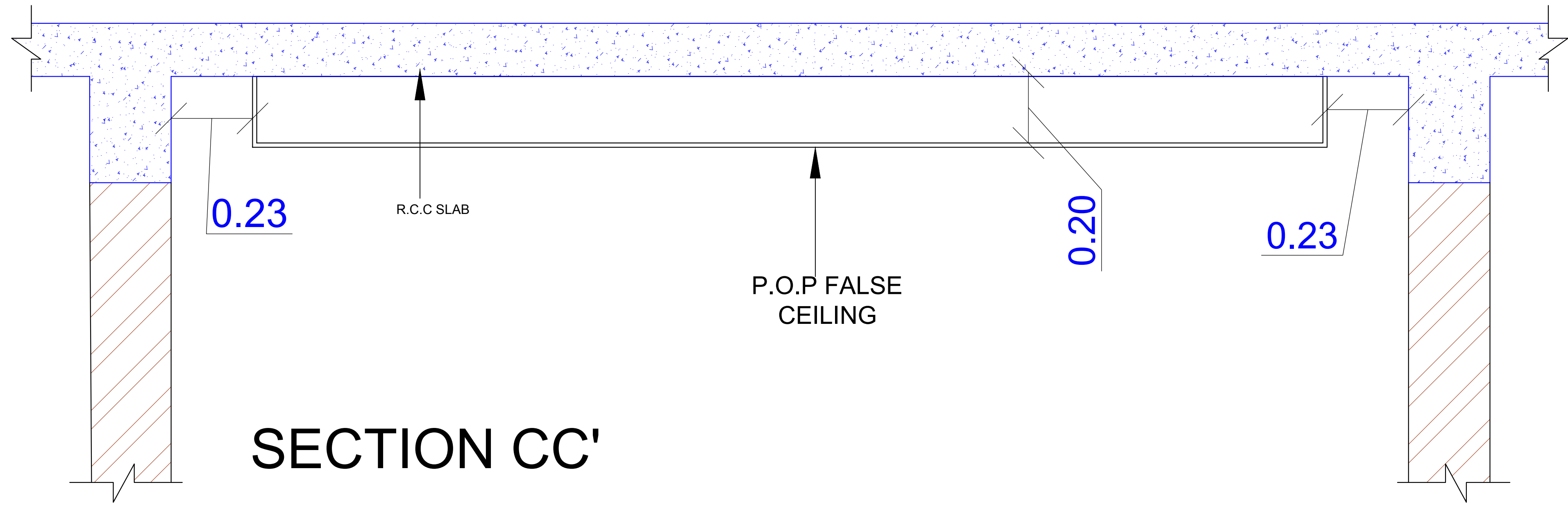

SECTION CC'

ARCHITECT:
NEERAV GUPTA
CA/2009/44766
L-1, KRISHNA MARG, C- SCHEME,
JAIPUR (302001), RAJASTHAN.
PH.0141-2360825 E-Mail-ravigupta_15@yahoo.com

PROJECT:
**PROPOSED RESORT AT
SAWAIMADHOPUR**

DRAWING TITLE:
**MAIN BUILDING
BASEMENT
TOILETS**

DRAWN BY:
RISHABH

SCALE:
NTS

DATE:
09-07-18

CHECKED BY:
**NEERAV
GUPTA**

NORTH >

SHEET NO. >

NOTES:
THE COPYRIGHT AND PROPERTY OF THIS DESIGN AND DRAWING
BELONGS TO **RAVI KUMAR GUPTA**. IT MUST NOT BE COPIED OR
REPRODUCED IN ANY MANNER WITHOUT THEIR WRITTEN
CONSENT. A LEGAL ACTION AS PER LAW MAY BE INITIATED
AGAINST THE OFFENDERS.