

SECTION F

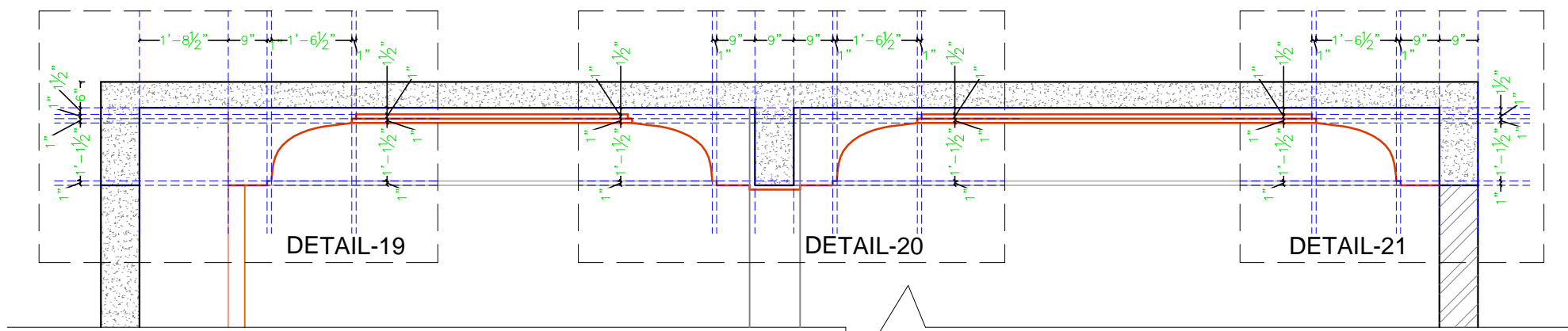

SECTION I

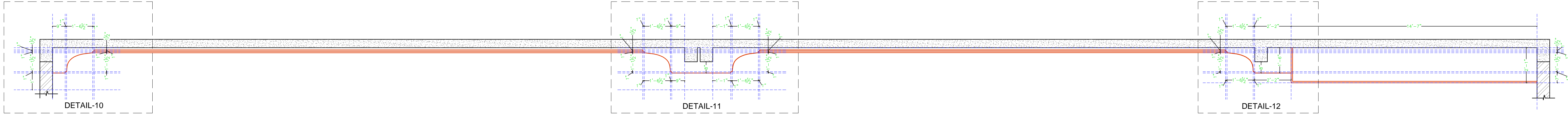

SECTION G

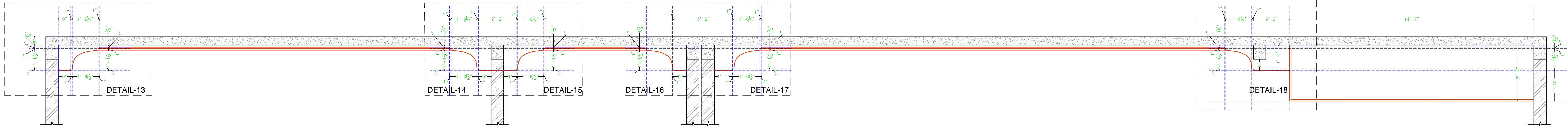

SECTION J

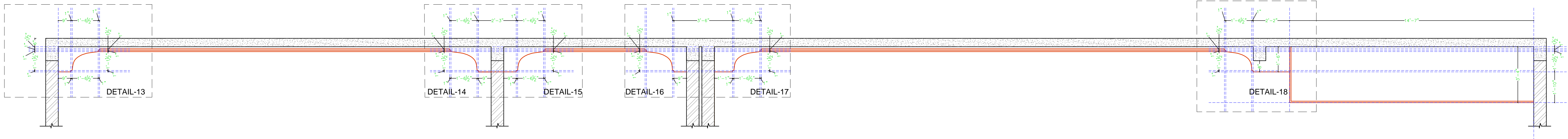

SECTION J

FALAKNUMA AREA FALL CEILING SECTION

ARCHITECT:  
**NEERAV GUPTA**  
L-1, KRISHNA MARG, C- SCHEME,  
JAIPUR (302001), RAJASTHAN.  
PH 0141-2380825  
E-Mail-architect\_neeravgupta@yahoo.com

PROJECT:  
  
**CLARKS LUCKNOW**

DRAWING TITLE:  
  
**FALAKNUMA AREA FALSE  
CEILING SECTION DETAIL**

DRAWN BY:  
**DEEPIKA**

SCALE:  
**N.T.S.**

DATE:  
**13-03-2019**

CHECKED BY:  
**NEERAV  
GUPTA**

SHEET NO :-  
**CA/BA/FAL/51**

NOTES:  
THE COPYRIGHT AND PROPERTY OF THIS DESIGN AND DRAWING  
BELONGS TO NEERAV GUPTA. IT MUST NOT BE COPIED OR  
REPRODUCED IN ANY MANNER WITHOUT THEIR WRITTEN  
CONSENT. A LEGAL ACTION AS PER LAW MAY BE INITIATED  
AGAINST THE OFFENDER.